

DUS SERIES

0.4mm PITCH FLOATING CONNECTOR FOR 16Gbps HIGH-SPEED TRANSMISSION



FEATURES

- ▶ Transmission characteristics that support high-speed serial transmission of 16 Gbps (NRZ, Sdd21:-3dB, @8GHz).
- ▶ Stack height is 3mm.
- ▶ Floating amount ± 0.4 mm in the XY directions.
- ▶ The effective mating length of 0.8mm.
- ▶ 40, 80, 100, 120, 140, 160, 180 and 200 pin available.
- ▶ Stacked mating is available.
- ▶ Operating temperature up to +125°C.
- ▶ Pattern wiring available beneath connector due to bottom side of receptacle covered with insulator.

ORDER CODE

DUS00- **S-T-**

① ② ③ ④ ⑤

*Please order in multiples of the quantity per package.

- ① **[Type]** Receptacle **DUS00** : Without positioning posts
- ② **[Number of contacts]** **040** : 40 pin **080** : 80 pin **100** : 100 pin **120** : 120 pin **140** : 140 pin **160** : 160 pin **180** : 180 pin **200** : 200 pin
- ③ **[Contact tail style]** **S** : Straight
- ④ **[Anti-dust tape]** **T** : With anti-dust tape
- ⑤ **[Number of packaging]** **No code** : 1,800pcs. per reel **500** : 500pcs. per reel

ORDER CODE

DUS10- **S-3-T-**

① ② ③ ④ ⑤ ⑥

*Please order in multiples of the quantity per package.

- ① **[Type]** Plug **DUS10** : Without positioning posts
- ② **[Number of contacts]** **040** : 40 pin **080** : 80 pin **100** : 100 pin **120** : 120 pin **140** : 140 pin **160** : 160 pin **180** : 180 pin **200** : 200 pin
- ③ **[Contact tail style]** **S** : Straight
- ④ **[Stacked height]** **3** : 3 mm
- ⑤ **[Anti-dust tape]** **T** : With anti-dust tape
- ⑥ **[Number of packaging]** **No code** : 3,200pcs. per reel **500** : 500pcs. per reel

SPECIFICATIONS

Material and plating		Electrical Characteristics	
Insulator material	Glass-filled LCP(UL94V-0), Black	Rated current	0.4A per contact (In the case of simultaneously energizing: 60 pin or less)
Contact material	Copper alloy		
Contact plating	(Contact area) Gold over Nickel (Terminal area) Gold over Nickel	Contact resistance	80mΩ max.
Retention clip material	Copper alloy	Dielectric withstanding voltage	200V AC for 1 minute
Retention clip plating	Tin over Nickel	Insulation resistance	100MΩ min. at 250V DC
Material of anti-dust tape	Polyimide	Operating temperature	-40°C to +125°C

*Please contact our sales representative about the case of simultaneously energizing

Floating structure

When the connector is mounted on the printed circuit board, a position error in the two directions of horizontal and vertical (XY direction) may occur at both connectors. In addition, if each printed circuit board is fixed to a case by screws after mating connectors, the connectors may have to compensate for the position error because a gap occurs during screwing the printed circuit board. A connector having a tolerance to compensate for such an error or gap caused by vibration is called a floating connector.

The DUS series is a 0.4mm fine pitch connector with $\pm 0.4\text{mm}$ floating structure and ensures sufficient compensation for position errors.

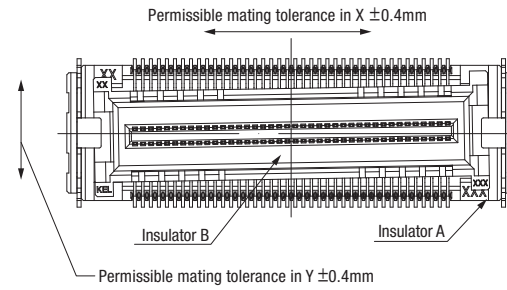

Mating drawing

Unit : mm

◆ Stacked mating Stack height : 3mm

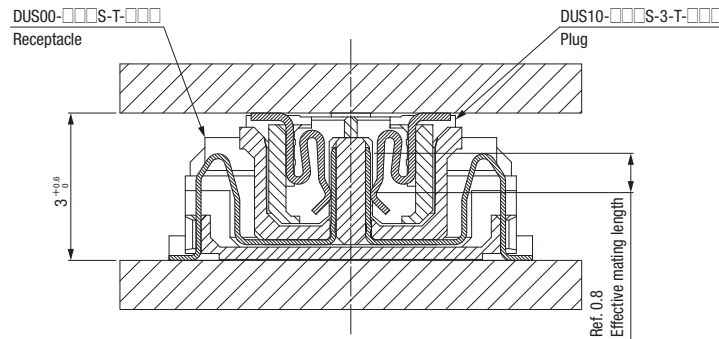

DUS00-□□□S-T-□□□ (Receptacle, Straight)

Unit : mm

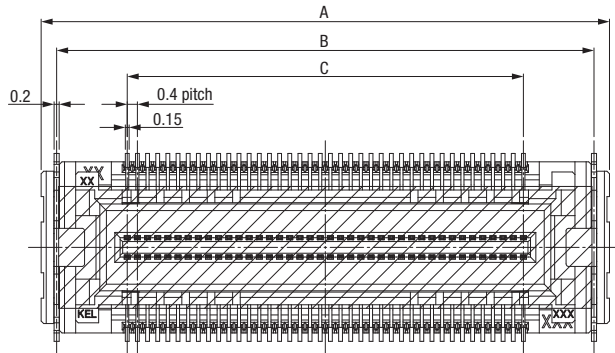

▶ Printed Circuit Board layout (Component side view)

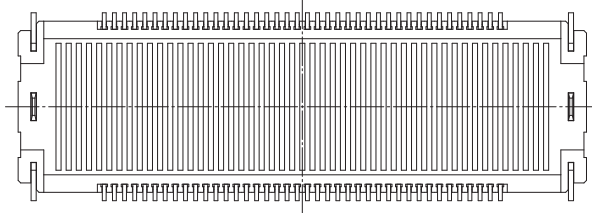
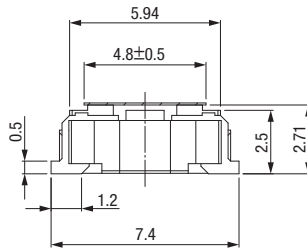
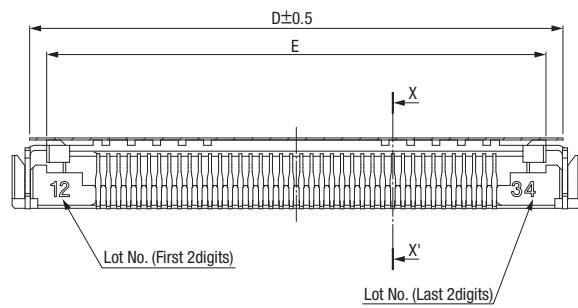
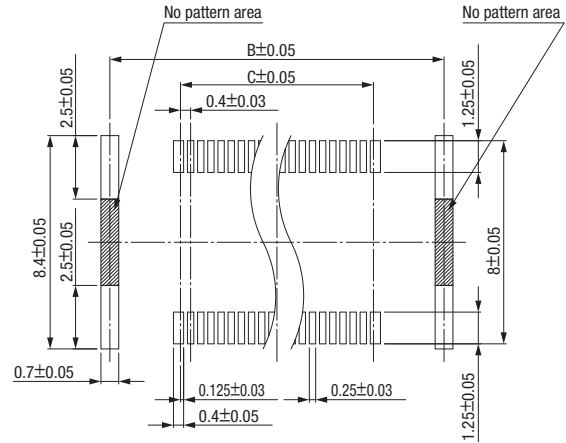

X-X' Cross section

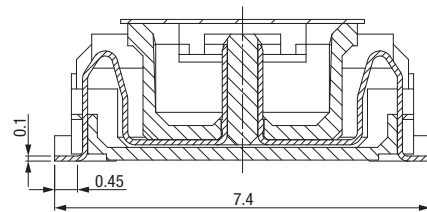

Packaging style

Embossed tape

▶ Product table

Part number	No. of packaging
DUS00-□□□S-T	1,800
DUS00-□□□S-T-500	500

▶ Product table / Dimensions

No. of contacts	Part number	A	B	C	D	E
40	DUS00-040S-T-□□□	14.38	13.16	7.6	13	11.66
80	DUS00-080S-T-□□□	22.38	21.16	15.6	21	19.66
100	DUS00-100S-T-□□□	26.38	25.16	19.6	25	23.66
120	DUS00-120S-T-□□□	30.38	29.16	23.6	29	27.66
140	DUS00-140S-T-□□□	34.38	33.16	27.6	33	31.66
160	DUS00-160S-T-□□□	38.38	37.16	31.6	37	35.66
180	DUS00-180S-T-□□□	42.38	41.16	35.6	41	39.66
200	DUS00-200S-T-□□□	46.38	45.16	39.6	45	43.66

DUS10-□□□S-3-T-□□□ (Plug, Straight)

Unit : mm

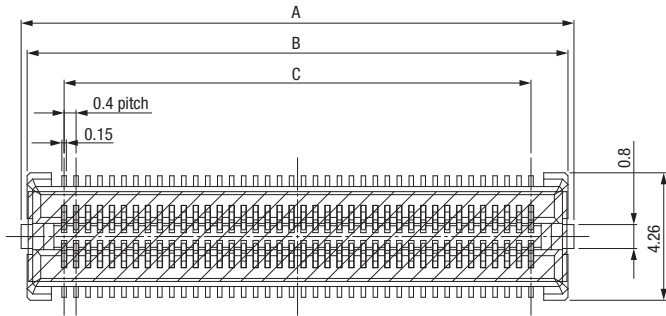

▶ Printed Circuit Board layout (Component side view)

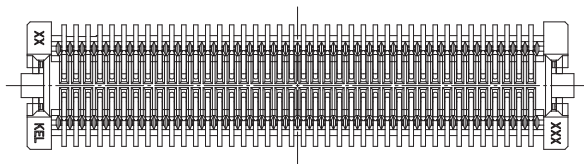
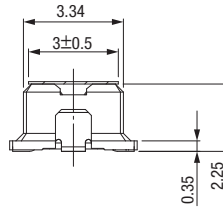
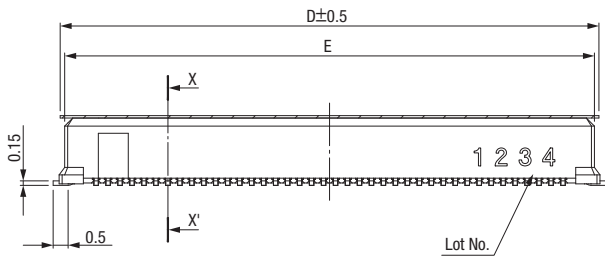
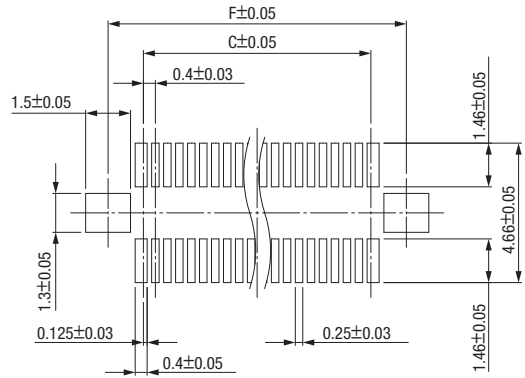

X-X' Cross section

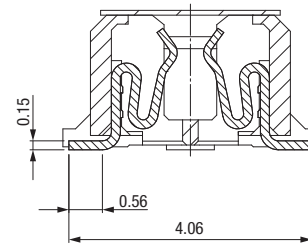

Packaging style

Embossed tape

▶ Product table

Part number	No. of packaging
DUS10-□□□S-3-T	3,200
DUS10-□□□S-3-T-500	500

▶ Product table / Dimensions

No. of contacts	Part number	A	B	C	D	E	F
40	DUS10-040S-3-T-□□□	10.47	10.07	7.6	10	9.7	9.97
80	DUS10-080S-3-T-□□□	18.47	18.07	15.6	18	17.7	17.97
100	DUS10-100S-3-T-□□□	22.47	22.07	19.6	22	21.7	21.97
120	DUS10-120S-3-T-□□□	26.47	26.07	23.6	26	25.7	25.97
140	DUS10-140S-3-T-□□□	30.47	30.07	27.6	30	29.7	29.97
160	DUS10-160S-3-T-□□□	34.47	34.07	31.6	34	33.7	33.97
180	DUS10-180S-3-T-□□□	38.47	38.07	35.6	38	37.7	37.97
200	DUS10-200S-3-T-□□□	42.47	42.07	39.6	42	41.7	41.97